

# LEDCLIP

LED lamp with clip fixing, wireless and transportable, install it wherever you want!

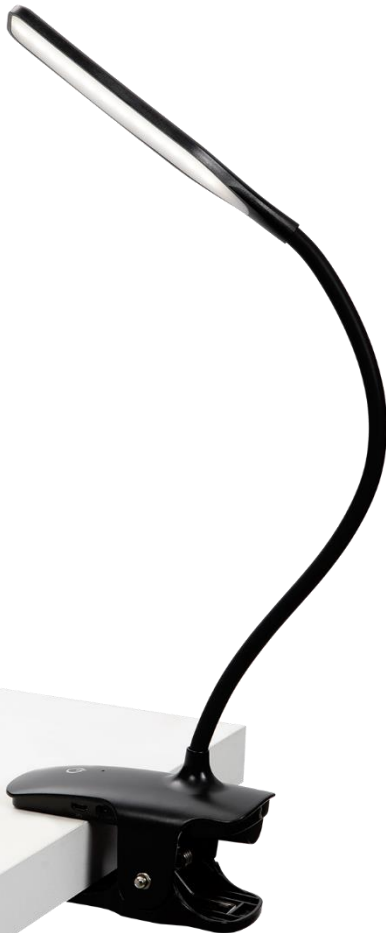

Wireless autonomous lamp: 10 hours of autonomy  
Rechargeable via USB port (cable supplied)

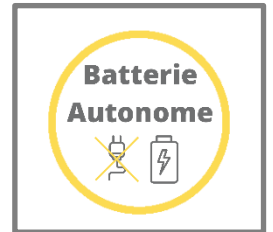

Clamp for secure attachment to any support  
(maximum opening: 7.5 cm)  
+ Possibility to put the lamp on its base



Touch Control button  
Dimmer switch (3 levels)  
+ On/off switch on the battery clamp.

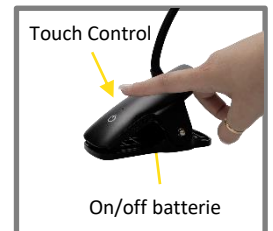

Flexible arm to adjust the direction  
of the light as you wish.



Excellent light diffusion thanks to the integrated 2.8W long-life LED panel (25000h) which provides high quality lighting and low energy consumption.



Ergonomic and practical thanks to its 100% flexible arm that can be rotated 360°, with a dimmer for personalized lighting.



Wireless, mobile and autonomous 10H LED lamp with integrated battery, rechargeable via USB cable.

LED lamp with clip fixing , wireless and transportable, install it wherever you want!

PRODUCT FEATURES	
Reference	<b>LEDCLIP N</b>
EAN	3129710017737
Materials	ABS / metal / silicone (Soft touch)
Colors	Black
Light source	LED
Product dimensions	Head : 15 x 3 cm
	Arm : 26 cm
	Base :12 x 6 cm
	Clamp maximum opening: 7.5 cm
Power source	Weight : 200 g
	Rechargeable via USB port (cable supplied) 10 hours of autonomy
Bulb type	LED panel 2,8 W (25 000 H)
LED panel lifetime	25000 hours / 30 years
Electrical power/watts	2,5 W
Light power	120 - 150 Lumens (lm) / 6000 Kelvin (K)
Colour rendering index (CRI)	> 80 Ra
Energy class	G
Standard	EC
Environmental impact	90% recyclable
Guarantee	3 years
Origin	French design and development - Manufacturing in PRC

PACKAGING DIMENSIONS	
* sales unit (x1SU) box	Dim. : L.9,5 cm x W. 8 cm x H.17 cm
	Weight : 2,75 Kg
* box master (x48SU)	Dim. : L.50,5 cm x W.40 cm x H.36 cm
	Weight : 14,30 Kg
Environmental impact	100% recyclable

