

EVOLVE THE WAY YOU WORK



MORE THAN HEADSETS: A WORKPLACE EVOLUTION

Jabra Evolve 80 is a professional headset that eliminates noise and helps you get in your concentration zone and focus. With smartphone connectivity, you can take your concentration zone wherever you are going; work, at the office, at home, travelling or commuting, for calls or simply enjoying music.





UNRIVALLED NOISE-CANCELLATION

Built to eliminate noise, Jabra's unique active noise-cancellation (ANC) filters out low-frequency background noise. Uniquely designed ear cushions block high-frequency sounds so you can enjoy your music or phone calls without distraction. The noise-cancelling microphone makes sure that you and the other party can hear each other loud and clear.

SIMPLE PLUG-AND-PLAY SETUP

Works straight out of the box with all leading UC systems. Installation is as easy as simply plugging it into the USB port or 3.5 mm jack to your laptop, or by using the 3.5 mm jack straight into your smart device.

INTUITIVE CONTROL UNIT

Get easy access at your fingertips to the most used functions, such as call , volume   and mute .

SIGNAL YOUR AVAILABILITY

Whether you are on a call or working on a task needing your full attention, the Jabra EVOLVE™ 80 has an integrated busy light on the ear cups, letting people around you clearly see your availability. You can activate the red busy-light to create your own concentration zone and keep you from being disturbed whenever required. Evolve 80 makes a great travelling companion too in noisy airports and public environments for phone calls or for music and relaxation. You can take your concentration zone wherever you need to go.



FEATURES AT A GLANCE

- Unique active noise-cancellation
- Made for voice and music enjoyment
- Passive noise-cancellation
- Integrated busy-light on the ear cups
- Discreet boom-arm that clips into the headband when you're listening to music
- Works with all smart devices
- Listen-in button – simply press the right ear cup button and you can hear announcements without removing the headset
- Easy call management via control unit

QUICK START GUIDE - GET STARTED IN UNDER 5 MINUTES

1 CONNECTING

CONNECT TO A PC (WITH CONTROLLER)

Fully plug the headset into the controller and connect the controller to a USB port on the PC.

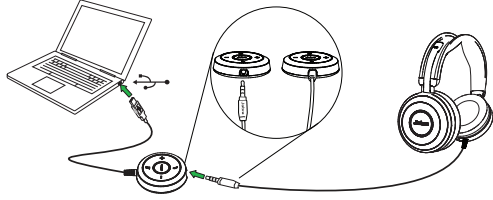

CONNECT TO A MOBILE DEVICE (WITHOUT CONTROLLER)

Plug the headset directly into your mobile device.

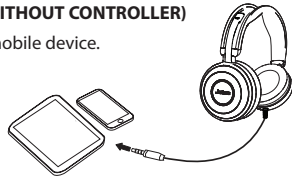

2 WEARING

It is recommended that you position the microphone close to your mouth (2 cm). The microphone is bendable for personal preference.

When listening to music or when outdoors, the microphone can be stored in the headband groove.



FOLD-FLAT STORAGE

The ear cups can be folded flat for easy storage. The microphone must be removed from the headband groove and swivelled backwards before folding the ear cups flat.

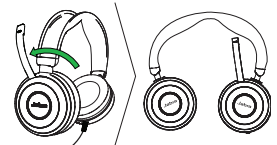

3 USING

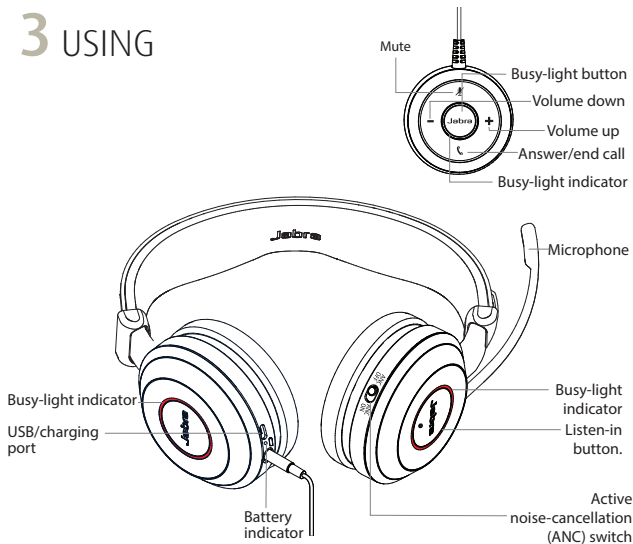

DID YOU KNOW?

You can download the full user manual from jabra.co.uk/evolve80

	FUNCTION	ACTION
	Answer/end call	Tap the Answer/end button
	Reject call	Double-tap the Answer/end button
	Adjust speaker volume	Tap the Volume up or Volume down button
	Busy-light	Tap the Busy-light button
	Mute/unmute	Tap the Mute button, or swivel the microphone up (mute) or down (unmute)
	FUNCTION	ACTION
	Active noise-cancellation (ANC)	Active noise-cancellation reduces outside disturbance. Slide the Active noise-cancellation switch on/off
	Listen in	Listen in lets outside sound into the headset. Tap the Listen-in button (ANC must be on)

CHARGING THE HEADSET

Normal use of the headset when connected to the controller will charge the battery. The headset will also charge when connected via USB cable.

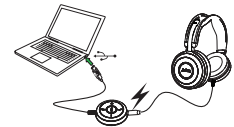

It takes approx. 3 hours to fully charge.

FEATURES AND TECHNICAL SPECIFICATIONS

- Made for voice calls and music
- Easy call management
- Active noise-cancellation
- Listen-in function
- Integrated busy-light
- Jabra Intelligent Call Transfer
- Discreet boom-arm
- Works with all smart devices

JABRA EVOLVE 80 VARIANTS

VARIANT	VARIANT NAME	DESCRIPTION	DESIGNED FOR
	Jabra Evolve 80 UC stereo <i>Item: 7899-829-209</i>	Corded stereo headset for VoIP softphone, mobile phone and tablet	<ul style="list-style-type: none"> ▪ Premium sound experience. ▪ Active noise-cancellation technology and large around-the-ear cups designed to reduce unwanted noise. ▪ USB adapter with 3.5 mm jack integrated into the control unit allows you to easily connect your headset to your PC, smartphone or tablet. ▪ Busy-light signals user availability. ▪ Microphone boom-arm can be integrated into the headband when not on a call or simply listening to music. ▪ Microphone mute, when boom-arm is turned upwards towards the headband. ▪ Leatherette ear cushions. ▪ Soft pouch included. ▪ Listen-in feature.
	Jabra Evolve 80 MS stereo <i>Item: 7899-823-109</i>	Certified for Skype for Business stereo headset for VoIP softphone, mobile phone and tablet	