

# Setup – How to assemble your Oryx JR stand

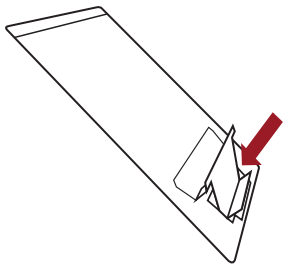

1. Push to form laptop/  
document **support**.

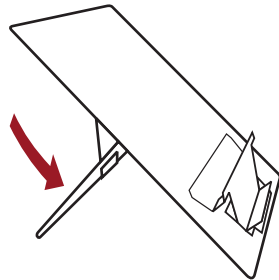

2. Unfold **rear support**.

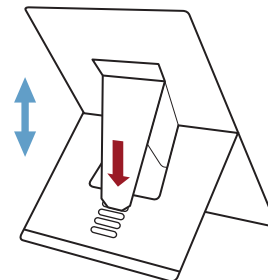

3. **Select one of four**  
**height settings**.

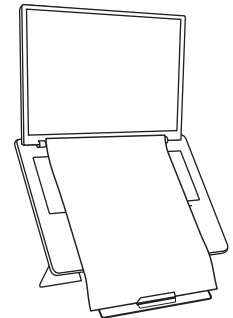

4. Place laptop and document  
on stand to view.

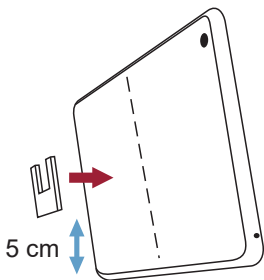

5. Remove transparent  
protective film from  
**U- shaped tab** and stick  
firmly to the back of the  
tablet on the **centre-line**  
approximately 5 cm from  
the bottom.  
[Tip: use measure on the  
side of this sheet printed  
at real size, no scaling]

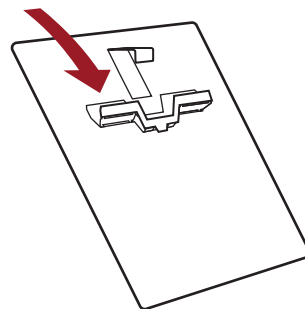

6. Follow steps 2 & 3 above and  
set-up the stand on highest  
setting. Extend the tablet  
**support** and place tablet  
in position.

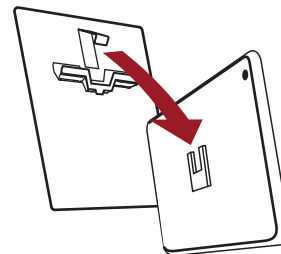

7. Push out the **retaining**  
**tongue** on the stand, fold  
down the end section and  
tuck it down into the  
**U-shaped tab**.



8. Position the stand on your  
desk about an arm's length  
away. Add an external mouse  
and keyboard to create an  
ergonomic workstation.