

Setup – How to assemble your Oryx PRO stand

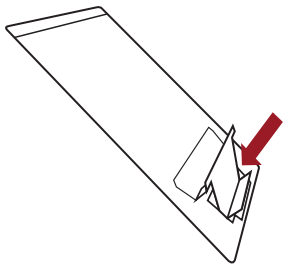

1. Push to form laptop/
document **support**.

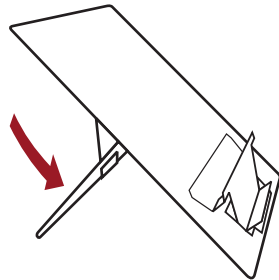

2. Unfold **rear support**.

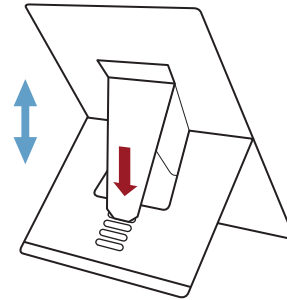

3. **Select one of four**
height settings.

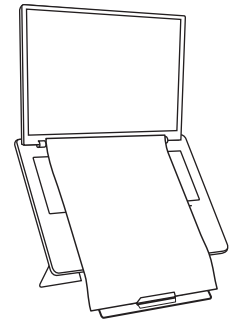

4. Place laptop and document
on stand to view.

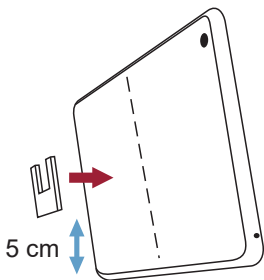

5. Remove transparent
protective film from
U- shaped tab and stick
firmly to the back of the
tablet on the **centre-line**
approximately 5 cm from
the bottom.
(Tip: use measure on the
side of this sheet printed
at real size, no scaling)

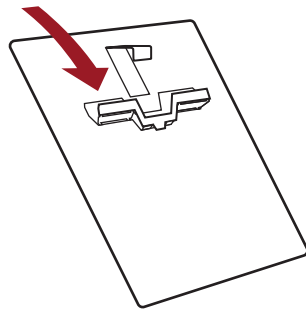

6. Follow steps 2 & 3 above and
set-up the stand on highest
setting. Extend the tablet
support and place tablet
in position.

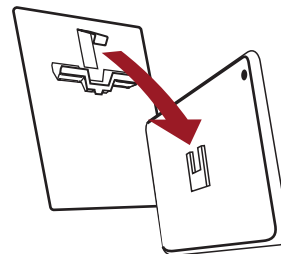

7. Push out the **retaining**
tongue on the stand, fold
down the end section and
tuck it down into the
U-shaped tab.

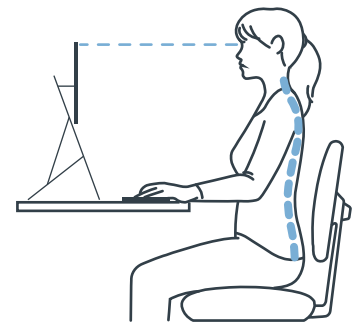

8. Position the stand on your
desk about an arm's length
away. Add an external mouse
and keyboard to create an
ergonomic workstation.