

Piano II BT

compact bluetooth keyboard



Key Features and Benefits

Compact & Portable: Designed for professionals who need a space-saving, portable keyboard.

Bluetooth Connectivity: Provides a wireless, cable-free connection for added convenience.

Long Battery Life: Ensures extended use on a single charge, perfect for busy workdays.

Ergonomic Key Design: Supports comfortable typing, minimizing wrist strain.

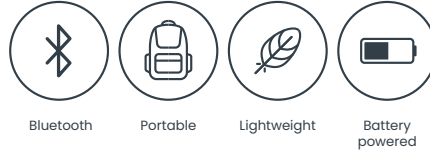

Bluetooth

Portable

Lightweight

Battery powered

Quick Technical Specifications

Batteries	2 x AAA (not included)
Colour	black
Net weight and size	300 g; 285 x 118 x 18 mm
Package weight and size	350 g; 290 x 125 x 25
Product code	ST352020

Keyboard Ergonomics

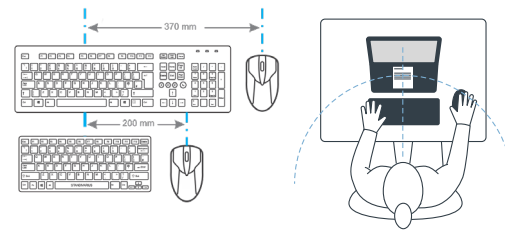

Reasons to Buy

Helps You Work Flexibly: Compact and portable design lets you carry it with ease, wherever you go.

Keeps Your Desk Clean: Bluetooth connectivity helps you keep your workspace free from cables.



standivarius
DMR Ergonomics SRL
Calea Circumvalatiunii nr 37 / 27
300671 Timisoara
Romania

UK: uk@standivarius.com / ++ 44 115 647 7406
Northern Europe (SE, FI, DK, NO): nordics@standivarius.com / ++46 10 551 6270
Benelux (B, NL, L): benelux@standivarius.com / ++40 723 014912
DACH (D, A, CH): dach@standivarius.com / ++40 728 160023
Other: office@standivarius.com / ++40 728 160023



standivarius.com